



**Frantic**  
theatre company

Magical  
performances  
Best show ever  
What energy!

Excitement!! FANTASTIC!! GREAT VALUE FOR MONEY

outstanding  
entertainment.

Great night  
Non Stop entertainment

171  
Class act ...

A brilliant show - money well spent

'moments of ANARCHIC BEAUTY' - Time Out

'TRULY INSPIRED' - The Big Issue

'HIGHLY ORIGINAL' - The Stage

'BELLYLAUGHS GUARANTEED' - The Irish Post

**Order your show today!**  
**0870 165 7350**  
bookings@frantictheatre.com



Does your house need cheering up?

## WHAT DO WE DO?

Frantic Theatre Company **perform** innovative, thought-provoking and breathtakingly entertaining **one-man musical theatre** shows, each 45 minutes long, delivered fresh to your front door.

We call this In-House-Theatre and it's totally different.

**IN-HOUSE-THEATRE** - Yes, you book your own theatre show!

- whether that be for friends, family and colleagues in your own home, or place of work, or school or even at your local hall (if your thinking big).

We also specialise in **outreach work**, taking the healing power of live professional theatre to the most disadvantaged, particularly those in hospitals, hospices and long-term residential care.



**'moments of anarchic beauty'**

- time out

**'truly inspired'**

- the big issue



## HOW DO WE DO IT?

Simple, we've broken all the rules and have come up with a form of infectious comedy that aims to be all things to all people, young or old alike.

With quick fire character changes, ridiculous costumes & high-energy musical-theatre and dance, we take diabolical liberties with the greatest songs, sketches, poetry and monologues of the last 100,000 years.

From Marie-Lloyd to Monty Python, from Gracie Fields to Gershwin, from high to low and back again, we call this phenomenon 'New-Time-Music-Hall'. With over 10,000 shows since 1990, it really does beat slobbering out in front of the telly.



**'bellylaughs guaranteed'**

- irish post



## WHY DO WE DO IT?

Good question! Thank-you for your concern.

## WHERE DO WE DO IT?

Your own living room, drawing room, lounge, garden, garden centre, stately home, village hall, Womens Institute, arts centre, theatre, TV/media centre, comedy club, hospital, hospice, charity do, conference centre, factory canteen, office, business premises, farm, sheltered housing complex, prison, school, youth club, mental health institution, day centre, palace, political club, British Legion club, hotel, pub, beach, residential care organisation, students union, conservatory, church, church hall, housing association, high-rise flat, drama school, library, college, clinic, government department, caravan club, and, when the weathers fine, in one of your fields!

For further ideas and information on these venues visit [www.frantictheatre.com/venues/](http://www.frantictheatre.com/venues/)

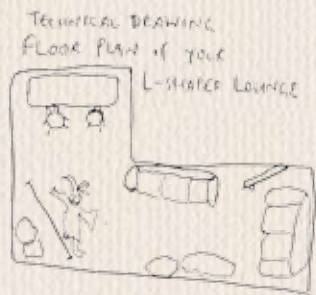

## COME OFF IT, HOW MUCH DOES IT ALL COST?

One show booked during our tour schedule (see next page for details) costs only **£150 + VAT**, Two or more of these shows booked together cost a mere **£120 + VAT** each. Bargain.

Think about it, for an audience of 20 booking, say, two brand new shows a year apart, that works out at **about £7 per person** per show - That's cheaper than a pizza delivered to your door!

Prices for performances outside of our tour dates start from just **£250 + VAT** per show, so to find out our availability for really special events and occasions just call us on 0870 165 7350.

## WHAT WE REQUIRE

**An audience**  
(anything between 5 to 155 people)

**A living room**  
(really, no room too small)

**A plug socket**  
(for our music)

**A table**  
(for costumes & props)

**A changing room**  
(anywhere in-doors)

**'highly original'**

- the stage



## WHAT'S IT LIKE?

Fancy taking a gander? Can't wait for us to arrive? We have a compendium of video clips available on our website for your viewing pleasure at [www.frantictheatre.com](http://www.frantictheatre.com), and for those of you who might want a bit more we also have two recent shows available on DVD and Video.



To order 'Tiddley-Om-Pom-Pom' / 'You Hum It-I'll Play It' on DVD or Video for £10 each + £2.50 p&p you can either: Phone **0870 165 7350** (if we're out performing, please leave a message) or you can purchase through our secure [online shop](#).

**4  
NEW  
SHOWS**



**THE TOP**

- SCOTLAND
- Cumbria
- Tyne & Wear
- Durham & Cleveland
- Northumberland
- Yorkshire & North Humberside
- Lancashire (incl. Manchester)
- Cheshire & Merseyside

	<b>Turn Off, Tune Up, Drop In!</b>	<b>You Have Been Watching...</b>	<b>Can I Do You Now Sir?</b>	<b>A Little of What You Fancy</b>
	<b>AUG 07 - JAN 08</b>	<b>FEB 08 - JULY 08</b>	<b>AUG 08 - JAN 09</b>	<b>FEB 09 - JULY 09</b>
	2-7 January 08	30 June - 5 July 08	5-10 January 09	29 June - 4 July 09
	2-7 January 08	30 June - 5 July 08	5-10 January 09	29 June - 4 July 09
	17-22 September 07	24-29 March 08	22-27 September 08	23-28 March 09
	15-20 October 07	21-26 April 08	20-25 October 08	20-25 April 09
Lincolnshire & South Humberside	Sold Out	10-15 March 08	8-13 September 08	9-14 March 09
Peterborough area	Sold Out	10-15 March 08	8-13 September 08	9-14 March 09
Nottinghamshire	Sold Out	10-15 March 08	8-13 September 08	9-14 March 09
Derbyshire & The Peak District	Sold Out	10-15 March 08	8-13 September 08	9-14 March 09
Northamptonshire	14-19 January 08	14-19 July 08	19-24 January 09	13-18 July 09
Leicestershire & Rutland	14-19 January 08	14-19 July 08	19-24 January 09	13-18 July 09
West Midlands & Warwickshire	14-19 January 08	14-19 July 08	19-24 January 09	13-18 July 09
Staffordshire	14-19 January 08	14-19 July 08	19-24 January 09	13-18 July 09
Shropshire	12-17 November 07	19-24 May 08	17-22 November 08	18-23 May 09
WALES	29 Oct - 3 Nov 07	5-10 May 08	3-8 November 08	4-9 May 09
Herefordshire & Worcestershire	29 Oct - 3 Nov 07	5-10 May 08	3-8 November 08	4-9 May 09
Gloucestershire	29 Oct - 3 Nov 07	5-10 May 08	3-8 November 08	4-9 May 09

**THE MIDDLE**



**THE BOTTOM**

- Norfolk & Suffolk
- Essex (outside of M25)
- Bedfordshire & Cambridgeshire
- Hertfordshire
- Berkshire & Buckinghamshire
- Oxfordshire
- Surrey & Sussex
- LONDON (anything within M25)
- Kent (outside M25 area)
- Hampshire & Wiltshire
- Isle of Wight
- Dorset & Somerset (incl. Bristol)
- Devon
- Cornwall

Norfolk & Suffolk	26 Nov - 1 Dec 07	2-7 June 08	1-6 December 08	1-6 June 09
Essex (outside of M25)	26 Nov - 1 Dec 07	2-7 June 08	1-6 December 08	1-6 June 09
Bedfordshire & Cambridgeshire	10-15 December 07	16-21 June 08	15-20 December 08	15-20 June 08
Hertfordshire	10-15 December 07	16-21 June 08	15-20 December 08	15-20 June 08
Berkshire & Buckinghamshire	1-6 October 07	7-12 April 08	6-11 October 08	6-11 April 09
Oxfordshire	1-6 October 07	7-12 April 08	6-11 October 08	6-11 April 09
Surrey & Sussex	1-6 October 07	7-12 April 08	6-11 October 08	6-11 April 09
LONDON (anything within M25)	SOLD OUT	11-16 February 08	11-16 August 08	9-14 February 09
Kent (outside M25 area)	10-15 December 07	16-21 June 08	15-20 December 08	15-20 June 08
Hampshire & Wiltshire	SOLD OUT	25 Feb - 1 March 08	25-30 August 08	23-28 February 09
Isle of Wight	SOLD OUT	25 Feb - 1 March 08	25-30 August 08	23-28 February 09
Dorset & Somerset (incl. Bristol)	SOLD OUT	25 Feb - 1 March 08	25-30 August 08	23-28 February 09
Devon	SOLD OUT	25 Feb - 1 March 08	25-30 August 08	23-28 February 09
Cornwall	29 Oct - 3 Nov 07	5-10 May 08	3-8 November 08	4-9 May 09

**Show Times - 11am, 2pm, 4.30pm or 7.30pm (can vary)**  
**Show length: 45 minutes**

**Special One-Off Performances**

Yes its true, due to popular demand we now offer shows outside of our official tour times so now it's possible to book for that special occasion. Prices start from an incredible £250 + VAT for a show direct to your door! Please note: We expect these shows to be extremely sought after so we'd like to encourage you to enquire as early as you can to avoid disappointment.

